

Student Care Centre



Purpose of SCCs



- SCCs provide care and supervision after school hours to students who need it.
- Programmes, designed in collaboration with schools, can meet the broad range of a child's social, emotional, recreational, physical, intellectual and creative needs, and to reinforce learning for students who need additional support.



- The SCC at WGPS will begin operations from 4 Jan 2016
- Operated by Nascans (fully owned by Nascans and not franchised)
- Selected based on a thorough evaluation process of 16 bidders
- Good track record with 10 years experience with 18 school-based SCCs

Programmes



- Academic Guidance / Homework Supervision
- Character Building in alignment to school values
- Enrichment
 - Creative Writing
 - Mind Mapping
 - Outdoor games
 - Team building
- Holiday Enrichment (Music & Art)

Time	Level	Duration	Monday	Tuesday	Wednesday	Thursday	Friday
1.30pm	All	15minutes	Report to Nascans & Change-up				
2.00pm	All	30minutes	LUNCH				
2.30pm	P1	60minutes	Nap Time				
	P2 - P6	60minutes	Homework Supervision/ Subject Revision/ Spelling Practice				
3.30pm	All	30minutes	TEA BREAK				
4.00pm	All	60minutes	Additional Learning Support outside of Study Time				
5.00pm	All	75minutes					
	P1		[OUTDOOR] Power Engagement Activities @	Character Education @Classroom	[OUTDOOR] Line Dance Activity @ ISH	Creative Writing @ School Garden	Character Education @Classroom
	P2					Star Reader @ Level 1 Benches	
	P3					Mind Mapping , Power Memory @	
	P4 - P6					Canteen	
6.00pm	All	30minutes	SILENT READING / INDOOR INTERACTIVE ZONE				
6.30pm	All	30minutes	Prepare for Dismissal				

Proposed Layout

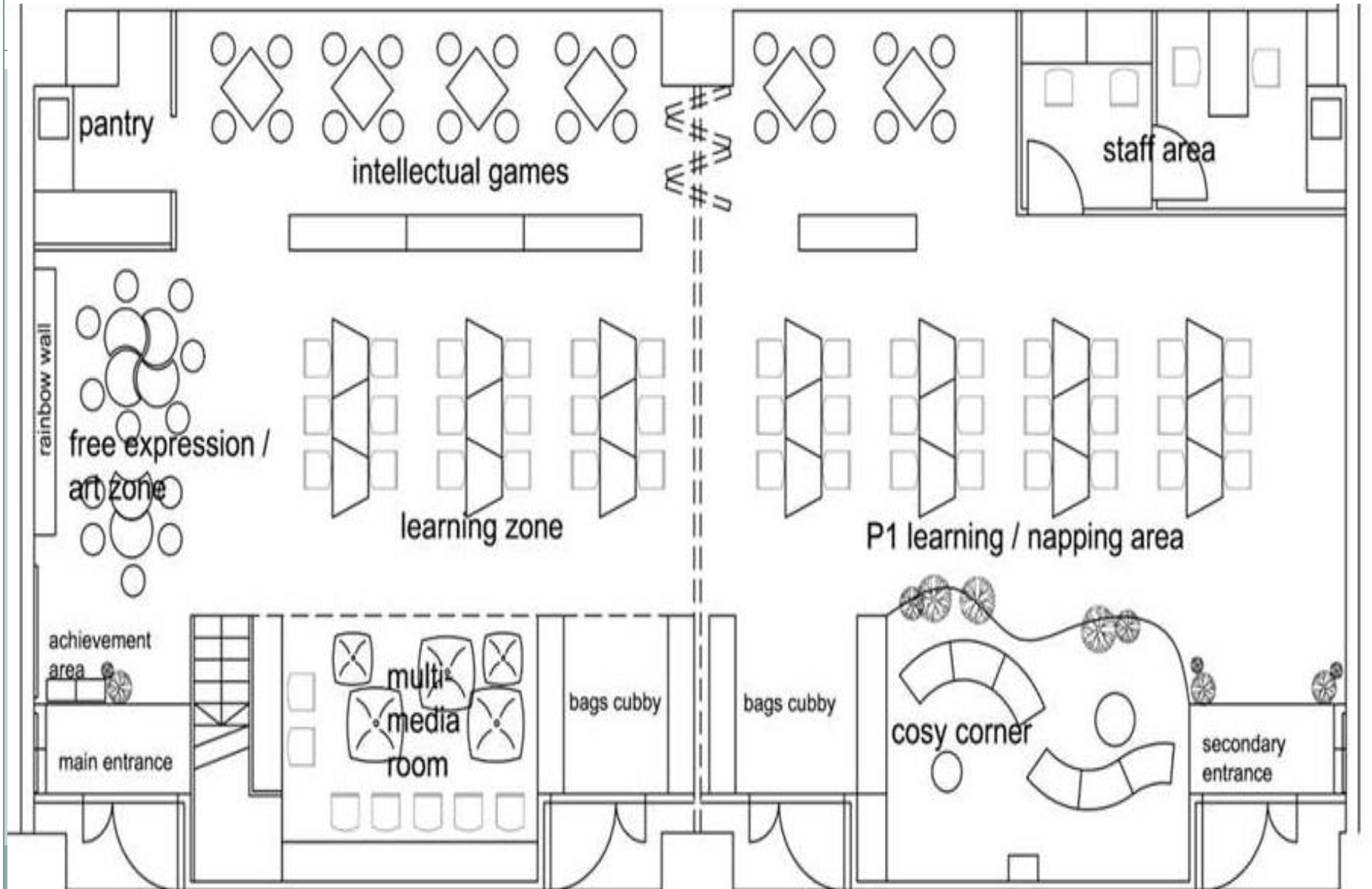



Nascans @ East Spring



NASCANS @ SHUQUN



Other Information



- A total of 60 places for 2016.
- 30 for Primary 1, 30 for Primary 2
- Priority consideration for:
 - Singaporeans / PR
 - Pupils on MOE Financial Assistance Scheme (MOE FAS)
 - Pupils with no home supervision
 - Pupils with no access to alternative childcare arrangements
- Registration at Canteen by today
- For pupils with siblings in upper Primary, if the younger sibling is enrolled, the older sibling can also be enrolled.
- Nascans will contact successful applicants by 30 November.
- Successful applicants must come to school to complete registration process on 1 Dec (2pm – 5pm)

Other SCCs nearby

(sourced from Google Maps)



Whispering Hearts Student Care Centre	617 Jurong West Street 65	6795 8967
Peach Tree Student Care Centre	735 Jurong West Street 75	6794 0879
Gifted Learners Student Care	823 Jurong West Street 81	8218 4222
Brilliant Student Care	838 Jurong West Street 81	6794 1529
YMCA Student Care Centre (Jurong West)	666B Jurong West Street 65	6794 7759
Holistic Student Care & Education Centre	718 Jurong West Street 71	6792 9157
Knowledge Park Education Centre Pte Ltd	728 Jurong West Ave 5	6790 0145
Baptist Student Care	714 Jurong West Street 71	6792 6026
i-Smart Learning Centre	713 Jurong West Street 71	9898 8900
Happy Kids	731 Jurong West Street 72	6793 6117
Pro-Teach Before & After School Care	863 Jurong West Street 81	6790 8815
The Learning Campus	263, Boon Lay Drive	6791 6626
Scholar Kids Student Care	720 Jurong West Ave 5	6795 7798
Whispering Hearts Infant & Child care	688 Jurong West Street 64	6792 2321
DStar Educare	729 Jurong West Ave 5	6792 7050
Brightsun Child Care Centre	635 Jurong West Street 65	6861 8745